



Agricultural Development Bank  
*Growing stronger together*

# IN-HOUSE ADVERTISEMENT-

10A 2R 24P of Freehold land with building thereon situate at LP #65 2MM Quinam Road, SIPARIA

Location Map For Residential Property Situated At Lp. No. 65, 2mm Quinam Road, Siparia

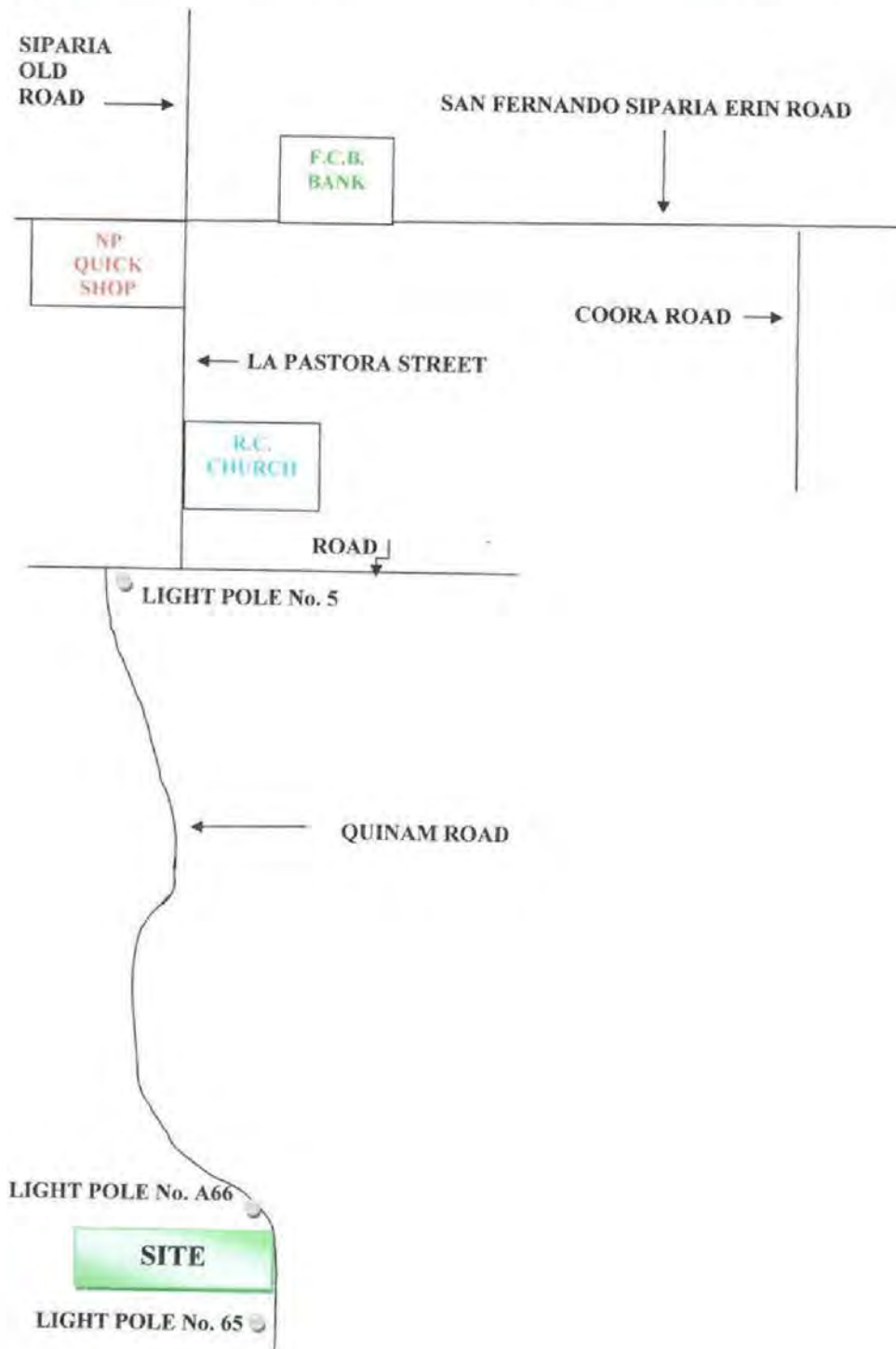



Agricultural Development Bank  
Growing stronger together

# IN-HOUSE ADVERTISEMENT-

10A 2R 24P of Freehold land with building thereon situate at LP #65 2MM Quinam Road, SIPARIA

## FARM MAP

PROJECT SITE: LP# 65 Quinam Road, Siparia

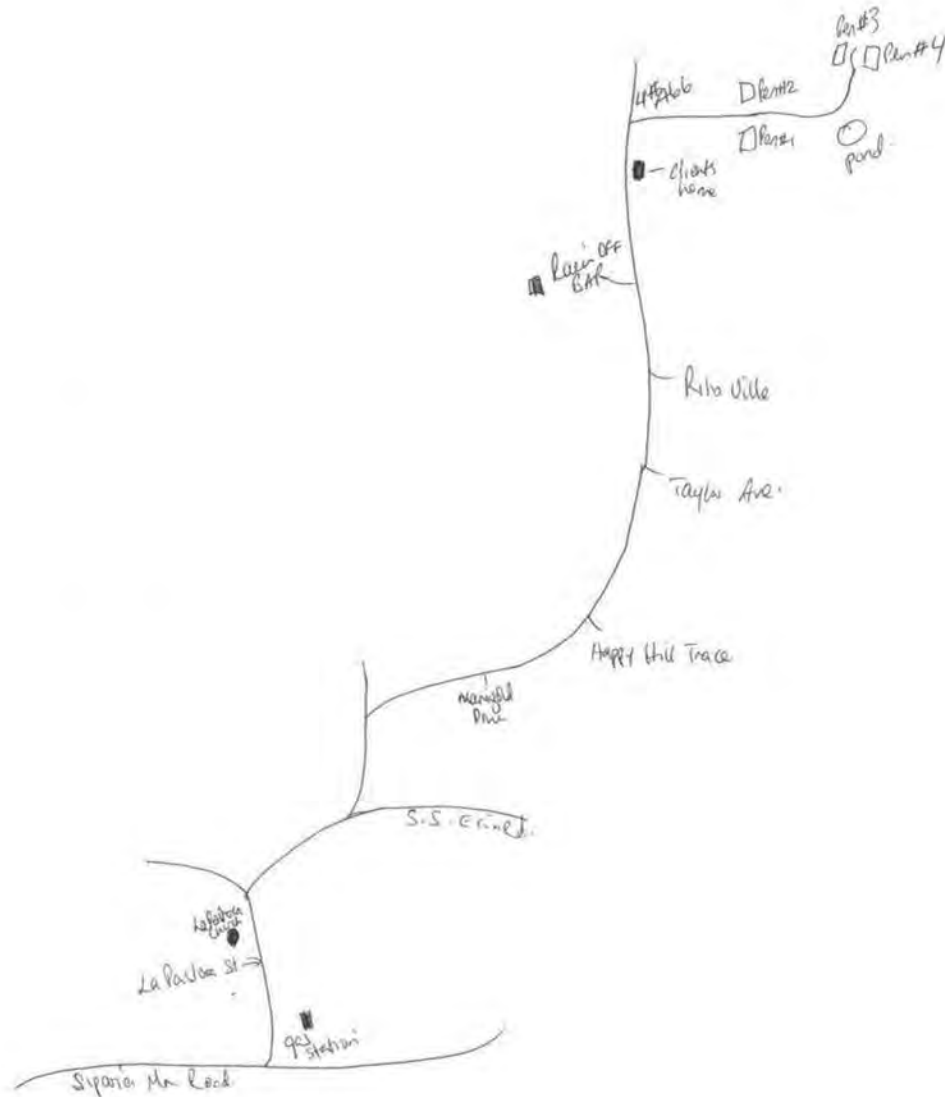
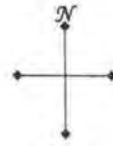



Agricultural Development Bank  
Growing stronger together

# IN-HOUSE ADVERTISEMENT-

10A 2R 24P of Freehold land with building thereon situate at LP #65 2MM Quinam Road, SIPARIA

ORDER No. \_\_\_\_\_

WARD of Oropuckie  
near Siparia

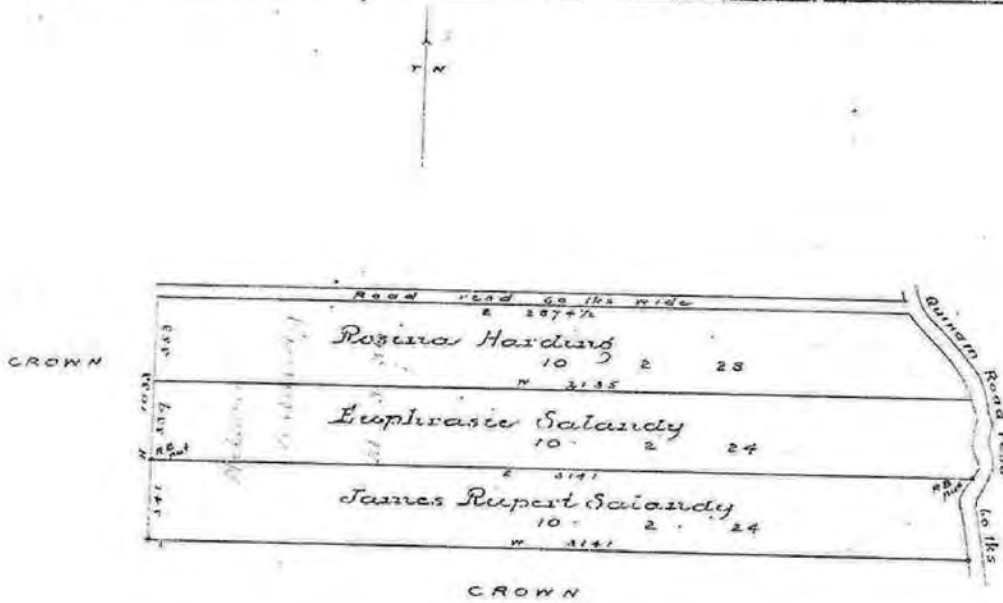

Entire original is shown

SCALE: One inch to 6 chs

PLAN of a Parcel of Land in the Ward of Siparia  
containing ten acres two rods & twenty-four perches  
surveyed by me, with due authority, in July 1920 for Jas. Rupert Salandy

Entered 5-5-23  
*[Signature]*

*[Signature]*  
Ag. E.C.S.  
12/5/20

*[Signature]*

dated, 26<sup>th</sup> March 1920.

Sworn Surveyor.



Agricultural Development Bank  
*Growing stronger together*

## IN-HOUSE ADVERTISEMENT-

10A 2R 24P of Freehold land with building thereon situate at LP #65 2MM Quinam Road, SIPARIA

**LOCATION:**

This Property is located at **BETWEEN LP. NO. 65, AND LP. NO. A66 ON QUINAM ROAD, OFF ROAD AT LP. 5, OFF LA PASTORA STREET AFTER LP. No. 4/1 (TURN RIGHT), OFF SAN FERNANDO SIPARIA ERIN ROAD AT N.P. GAS STATION, SIPARIA. IN THE WARD OF SIPARIA. IN THE REPUBLIC OF TRINIDAD AND TOBAGO** and further bounded as follows:

**NORTH:** By lands now or formerly of Euphiasie Salandy.

**SOUTH:** By lands now or formerly of Crown Lands.

**EAST:** By the Quinam Road reserve 60-links wide.

**WEST:** By lands now or formerly of Crown Lands.

The site comprises of **10 Acres, 2 Roods and 20 Perches**, approximately 10 and  $\frac{3}{4}$  acres, more or less, partly flat, and partly sloping steeply. On site stands a One – Storey wooden Residential Building Structure, a Ground Floor of a Two Storey concrete Residential Building Structure, a Flat concrete Residential building structure, four (4) chicken pens, a large shed connected to pens 3 & 4 and a pond.



**Agricultural Development Bank**  
*Growing stronger together*

## **IN-HOUSE ADVERTISEMENT-**

**10A 2R 24P of Freehold land with building thereon situate at LP #65 2MM Quinam Road, SIPARIA**



**SITE VIEW OF ONE-STOREY**



Agricultural Development Bank  
*Growing stronger together*

## IN-HOUSE ADVERTISEMENT-

10A 2R 24P of Freehold land with building thereon situate at LP #65 2MM Quinam Road, SIPARIA



**SITE VIEW OF GROUND FLOOR OF A TWO-STOREY**



Agricultural Development Bank  
*Growing stronger together*

## IN-HOUSE ADVERTISEMENT-

10A 2R 24P of Freehold land with building thereon situate at LP #65 2MM Quinam Road, SIPARIA



**BACK VIEW OF GROUND FLOOR OF A TWO-STOREY**



**Agricultural Development Bank**  
*Growing stronger together*

## **IN-HOUSE ADVERTISEMENT-**

**10A 2R 24P of Freehold land with building thereon situate at LP #65 2MM Quinam Road, SIPARIA**



**SITE VIEW OF FLATS**





**Agricultural Development Bank**  
*Growing stronger together*

## **IN-HOUSE ADVERTISEMENT-**

**10A 2R 24P of Freehold land with building thereon situate at LP #65 2MM Quinam Road, SIPARIA**



**SIDE VIEW OF FLATS**



Agricultural Development Bank  
*Growing stronger together*

## IN-HOUSE ADVERTISEMENT-

10A 2R 24P of Freehold land with building thereon situate at LP #65 2MM Quinam Road, SIPARIA



*VIEW OF CHICKEN PENS No. 1 & No. 2.*



**Agricultural Development Bank**  
*Growing stronger together*

## **IN-HOUSE ADVERTISEMENT-**

**10A 2R 24P of Freehold land with building thereon situate at LP #65 2MM Quinam Road, SIPARIA**



**VIEW OF CHICKEN PEN No. 1**



Agricultural Development Bank  
*Growing stronger together*

## IN-HOUSE ADVERTISEMENT-

10A 2R 24P of Freehold land with building thereon situate at LP #65 2MM Quinam Road, SIPARIA



*VIEW OF CHICKEN PEN No. 2*



Agricultural Development Bank  
*Growing stronger together*

## IN-HOUSE ADVERTISEMENT-

10A 2R 24P of Freehold land with building thereon situate at LP #65 2MM Quinam Road, SIPARIA



*VIEW OF CHICKEN PENS No. 3 & No. 4*



**Agricultural Development Bank**  
*Growing stronger together*

## **IN-HOUSE ADVERTISEMENT-**

**10A 2R 24P of Freehold land with building thereon situate at LP #65 2MM Quinam Road, SIPARIA**



***VIEW OF CHICKEN PEN No. 3***



Agricultural Development Bank  
*Growing stronger together*

## IN-HOUSE ADVERTISEMENT-

10A 2R 24P of Freehold land with building thereon situate at LP #65 2MM Quinam Road, SIPARIA



*SIDE VIEW OF CHICKEN PEN No. 3*



**Agricultural Development Bank**  
*Growing stronger together*

## **IN-HOUSE ADVERTISEMENT-**

**10A 2R 24P of Freehold land with building thereon situate at LP #65 2MM Quinam Road, SIPARIA**



**VIEW OF CHICKEN PEN No. 4**





**Agricultural Development Bank**  
*Growing stronger together*

## **IN-HOUSE ADVERTISEMENT-**

**10A 2R 24P of Freehold land with building thereon situate at LP #65 2MM Quinam Road, SIPARIA**



***VIEW OF LARGE SHED CONNECTED TO CHICKEN PENS No. 3 & No. 4***



**Agricultural Development Bank**  
*Growing stronger together*

## **IN-HOUSE ADVERTISEMENT-**

**10A 2R 24P of Freehold land with building thereon situate at LP #65 2MM Quinam Road, SIPARIA**



**INSIDE VIEW OF LARGE SHED CONNECTED**  
**TO CHICKEN PENS No. 3 & No. 4**



**Agricultural Development Bank**  
*Growing stronger together*

## **IN-HOUSE ADVERTISEMENT-**

**10A 2R 24P of Freehold land with building thereon situate at LP #65 2MM Quinam Road, SIPARIA**



**VIEW OF POND**



Agricultural Development Bank  
*Growing stronger together*

## IN-HOUSE ADVERTISEMENT-

10A 2R 24P of Freehold land with building thereon situate at LP #65 2MM Quinam Road, SIPARIA



**VIEW OF ACCESS TO CHICKEN PENS No. 3 & No. 4**



**Agricultural Development Bank**  
*Growing stronger together*

## **IN-HOUSE ADVERTISEMENT-**

**10A 2R 24P of Freehold land with building thereon situate at LP #65 2MM Quinam Road, SIPARIA**



**ACCESS ROAD TO PENS**



**Agricultural Development Bank**  
*Growing stronger together*

## **IN-HOUSE ADVERTISEMENT-**

**10A 2R 24P of Freehold land with building thereon situate at LP #65 2MM Quinam Road, SIPARIA**



**ROAD VIEW**



**Agricultural Development Bank**  
*Growing stronger together*

## **IN-HOUSE ADVERTISEMENT-**

**10A 2R 24P of Freehold land with building thereon situate at LP #65 2MM Quinam Road, SIPARIA**



**ROAD VIEW**